

PLANT SCHEDULE			
CODE	QTY	BOTANICAL / COMMON NAME	REMARKS
TREES			
BB	7	Bauhinia x blakeana / Hong Kong Orchid Tree	12" HT X 5" SPR, 2.5" CAL TRUNK @ MATURITY: 15" DBH
BA	11	Bulnesia arborea / Verawood	12" HT, X 5" SPR, 2.5" CAL, MIN.
BS	58	Bursera simaruba / Gumbo Limbo	12" HT, X 5" SPR, 2.5" CAL.
CP	136	Clusia rosea 'Pitch Apple' / Balsam Apple	12" HT X 5" SPR, 2.5" CAL.
CU	20	Coccoloba uvifera / Sea Grape	12" HT X 5" SPR., 3" CAL.
CE	3	Conocarpus erectus 'Sericeus' / Silver Buttonwood	12" HT X 5" SPR, 2.5" CAL.
CS	16	Cordia sebestena / Orange Geiger Tree	12" HT X 5" SPR, 2.5" CAL., SYMMETRICAL CANOPY, MATCHING.
DR	4	Delonix regia / Royal Poinciana	12" HT, X 5" SPR, 2.5" CAL, MIN.
ED	4	Elaeocarpus decipiens TM / Japanese Blueberry Tree	12" HT, X 5" SPR, NATURAL/STANDARD, NO SHAPING
ED2	30	Eucalyptus deglupta / Rainbow Eucalyptus	14" HT X 6" SPR, 2.5" CAL., SYMMETRICAL CANOPY, MATCHING.
FR	8	Ficus rubiginosa / Rustyleaf Fig	18" HT, X 8" SP.
FD	4	Filicium decipiens / Japanese Fern Tree	12" HT X 5" SPR, 2.5" CAL TRUNK @ MATURITY: 10" DBH
LS	71	Lagerstroemia speciosa / Queen's Crape Myrtle	12" HT X 5" SPR.
PC	22	Psidium littorale / Strawberry Guava	12" HT X 8" SPR., 2.5" CAL.,MULTI TRUNK
QV	202	Quercus virginiana / Southern Live Oak	16" HT, X 5" SPR, 2.5" CAL.
ACCENT TREES			
CH3	2	Chamaerops humilis / Mediterranean Fan Palm	MULTI-TRUNK, SPECIMEN, 10-12 FT. HT. OA.
LE	9	Licuala elegans / Licuala Palm	4' HT, x 4" SP.
TR	5	Thrinax radiata / Florida Thatch Palm	5' O.A. HT.
MITIGATION TREES			
M-DR	2	Delonix regia / Royal Poinciana	12" HT, X 5" SPR., 2.5" CAL, MIN.
M-LS	4	Lagerstroemia speciosa / Queen's Crape Myrtle	12" HT, X 5" SPR., 2.5" CAL.
M-PD	116	Pinus elliotii 'Densa' / Slash Pine	MIN. 12" HT, X 5" SPR, 2.5" CAL., STAGGERED HTS., (12'-33%/14'-33%/18'-33%)
M-QV	4	Quercus virginiana / Southern Live Oak	16" HT, X 5" SPR, 2.5" CAL.
M-SP	60	Sabal palmetto / Cabbage Palmetto	12" C.T.,18-22" O.A. HT, BOOTED, 6" MIN DIA.
PALM TREES			
AA	43	Archontophoenix alexandriae / King Alexander Palm	22-26" O.A. HT, 12"-16" G.W., SINGLE-TRUNK, MATCHING
AA3	8	Archontophoenix alexandriae / King Alexander Palm	22-26" O.A. HT, 12"-16" G.W., TRIPLE-TRUNK, MATCHING
DP	18	Phoenix dactylifera 'Medjool' / Date Palm	20" C.T., MATCHED, DIAMOND CUT, FLORIDA FANCY TRUNK @ MATURITY: 24"
PE	6	Phycosperma elegans / Alexander Palm	10'-18" C.T., 8" G.W. MIN., STAGGER HEIGHTS, COORD WITH L.A.
RE	31	Roystonea elata / Florida Royal Palm	22" G.W. MIN, MATCHED
SP	71	Sabal palmetto / Cabbage Palmetto	12" C.T.,18-22" O.A. HT, BOOTED, 6" MIN DIA.
VM	73	Veitchia montgomeryana / Montgomery Palm	22" O.A. HT, 10'-14" C.T., DOUBLE
VM3	12	Veitchia montgomeryana / Montgomery Palm	20" O.A. HT, 10'-14" C.T., TRIPLE TRUNK
RELOCATED TREES			
R-BS	1	Bursera simaruba / Gumbo Limbo	EXISTING TREE TO BE RELOCATED ON SITE
R-CD	1	Coccoloba diversifolia / Pigeon Plum	EXISTING TREE TO BE RELOCATED ON SITE
R-CN	1	Cocos nucifera / Coconut Palm	EXISTING TREE TO BE RELOCATED ON SITE
R-QV	6	Quercus virginiana / Southern Live Oak	EXISTING TREE TO BE RELOCATED ON SITE
R-SP	81	Sabal palmetto / Cabbage Palmetto	EXISTING TREE TO BE RELOCATED ON SITE
SHRUBS			
AA2	20	Agave attenuata / Foxtail Agave	18" HT, X18" SPR.
ALC	13	Alcantarea imperialis / Imperial Bromeliad	24" HT, X 24" SPR.
AO	39	Alcantarea odorata / Giant Silver Bromeliad	24" HT, X 24" SPR.
CH	953	Chrysobalanus icaco 'Horizontalis' / Horizontal Cocoplum	36" HT, X 36" SPR.
CLU	1,004	Clusia guittifera / Small Leaf Clusia	36" HT, X 24" SPR. @ 36" O.C.
FUR	12	Furcraea foetida 'Variegata' / Variegated False Agave	36"HT, X 36" SPR.
GS	14	Guaiacum sanctum / Lignum Vitae	36" HT, X 48" SPR., SPECIMEN
PM	1,936	Podocarpus macrophyllus / Yew Pine	36" HT, X 12" SPR.
STA	30	Strelitzia alba / White Bird of Paradise	36" HT, X 30" SPR. @36" O.C.
SHRUB AREAS			
AO2	46	Alcantarea odorata / Giant Silver Bromeliad	18" HT, X 18" SPR.
ALL	17	Allamanda cathartica 'Hendersonii' / Hendersonii Golden Trumpet	18" HT, X 18" SPR. @ 18" O.C.
ALO	220	Alocasia x 'Regal Shields' / Regal Shields Alocasia	32" HT, X 32" SPR. @ 36" O.C.
ASP	2,026	Asparagus densifloris 'Meyers' / Foxtail Fern	12" HT, X 12" HT. @ 18" O.C.
BEG	846	Begonia odorata 'Alba' / Giant White Angel Begonia	18" HT, x 18" SPR. @ 18" O.C.
CAR	6,208	Carissa macrocarpa 'Emerald Blanket' / Emerald Blanket Carissa	12" HT, X 12" SPR. @ 18" O.C.
CA	745	Chrysobalanus icaco 'Green Tip' / Green Tip Coco Plum	36" HT, X 36" SPR, X 36" O.C.
CH2	1,179	Chrysobalanus icaco 'Horizontalis' / Horizontal Coco Plum	18" HT, X 18" SPR. @ 24" O.C.
CRO	214	Codiaeum variegatum 'Magnificent' / Croton	24" HT, X 18" SPR. @ 24" O.C.
FIC	1,531	Ficus microcarpa 'Green Island' / Green Island Ficus	12" HT, X 12" SPR. @ 18" O.C.
HF	578	Hamelia patens 'compacta' / Dwarf Firebush	24" HT, X 24" SPR., FULL
HRS	27	Hibiscus rosa-sinensis / Pink Hibiscus	16" HT, X 12" SPR., Full to Base, Pink Flowers.
IRI	3,481	Iris virginica / Blue Flag Iris	12" HT X 12" SPR. @ 12" O.C.
IMS	722	Ixora coccinea 'Maui Sunset' / Maui Sunset Dwarf Ixora	12" HT, X 12" SPR. @ 18" O.C.
MIC2	429	Microsorium scolopendrum / Wart Fern	12" HT, X 12" SPR. @ 18" O.C.
MON	113	Monstera deliciosa / Split-leaf Philodendron	36" HT, X 24" SPR.
MUH	1,033	Muhlenbergia capillaris / Pink Muhly	18" HT, X 18" SPR. @ 24" O.C.
NER	128	Nerium oleander 'Pink Ice' / Dwarf Oleander	24" HT, x 18" SPR. @ 30" O.C.
PBM	842	Philodendron x 'Burle Marx' / Burle Marx Philodendron	18" HT, X 18" SPR. @ 18" O.C.
PM4	55	Podocarpus macrophyllus / Podocarpus	48" HT, x 24" SPR. @ 24"O.C.
PO2	112	Podocarpus macrophyllus 'Dwarf Pringles' / Dwarf Podocarpus	12" HT, x 12" SPR. @ 12"O.C.
SCH	32	Schefflera arboricola / Green Arboricola	30" HT X 30" SPR @ 36" O.C.
SC	322	Serenoa repens 'Cinerea' / Silver Saw Palmetto	24" HT, X 24" SPR.
GROUND COVERS			
ANN	498	Annual / Annual Flowers	BY CONTRACTOR
EVO	854	Evolvulus glomeratus 'Blue Daze' / 'Blue Daze'	12" HT X 12" SPR @ 12" O.C.
MIC	645	Microsorium scolopendria / Wart Fern	12" HT, X 12" SPR. @ 18" O.C.
TRA	4,074	Trachelospermum asiaticum 'Asiatic' / Asiatic Jasmine	6"HT, x 10" SPR. @ 10" O.C.

NOTES:
- ALL TREES WITH "M-" IN THE PLANT TAG ARE TO BE COUNTED TOWARDS THE MITIGATION REPLACEMENT REQUIREMENT.
- ALL AREAS LABELED AS SOD TO BE ST. AUGUSTINE UNLESS OTHERWISE STATED.
- A NOTARIZED CERTIFICATE OF VARIETY FOR THE MEDJOOOL SPECIES WILL BE REQUIRED AT TIME OF FINAL LANDSCAPE INSPECTION.

OVERALL SITE REQUIREMENTS CHART

ITEMS	CODE REQUIREMENT	REQUIRED	PROVIDED
STREET TREES (1,633 LF)	1 TREE PER 40 FT. W/ VARIETY	41 TREES	45 TREES (2 EXISTING CANOPY TREES, 1 SABAL PALM, 2 ROYAL PALM)
PERIMETER LANDSCAPE STRIP- 10' WIDTH PLANTING BUFFER (3,358 TOTAL LF PROVIDED)[1,673 LF ALONG R.O.W / 1,685 ABUTTING PL	1 CANOPY TREE / 30' O.C. ALONG R.O.W, 1 CANOPY TREE / 40' O.C. ABUTTING PL/V.U.A. CONTINUOUS 4' HT. SHRUBS/HEDGE	98 TREES (56 ROW, 42 VUA) CONT. HEDGE	82 CANOPY TREES (7 PRESERVED, 2 RELOCATES) 138 PALMS (68 RELOCATES) COCOPLUM HEDGE
MITIGATION TREES 2,934' DBH REMOVED	1" CALIPER FOR EACH 1" DBH OF NON-SPECIMEN TREE REMOVED	TOTAL REQUIRED 2,934' CALIPER	675' OF MITIGATION REPLACEMENT TREES FROM 126 TREES AND 60 PALMS(315' OF CANOPY, 360' OF PALMS)
DOLLAR VALUE FOR TREES REMOVED VS DOLLAR VALUE FOR TREES REPLACED	-	\$288,666 VALUE OF REMOVAL TREES	\$153,675 VALUE OF MITIGATION REPLACEMENT TREES

NOTES:
- ANY EXCESS MITIGATION REPLACEMENT REQUIREMENTS THAT ARE UNABLE TO BE MET WITH PLANTINGS ON THE SITE WILL BE HANDLED VIA CHECK TOTALING THE REMAINING MITIGATION AMOUNT OR PROVIDED WITHIN THE GOLF COURSE.

RESIDENTIAL - LANDSCAPE REQUIREMENT CHART

ITEMS	CODE REQUIREMENT	REQUIRED	PROVIDED
LOT LANDSCAPE - ZONING RM-4S (371,725 SF SITE AREA)	1 TREES/5 SHRUBS PER 3,000 SQ. FT.	124 TREES 620 SHRUBS	263 TREES TOTAL 104 TREES (4 RELOCATES) 159 PALMS 13,396 SHRUBS
VEHICULAR USE AREA INTERIOR LANDSCAPING (195,050 SF)	15% OF VEHICULAR USE AREA	29,258 SF	PROVIDED 17.9% (34,980 SF) OF INTERIOR LANDSCAPING IN VEHICULAR USE AREA.
PARKING ISLANDS	1 TREE PER ISLAND	64 TREES SOD	64 TREES SOD
PARKING MEDIANS (855 LF)	1 CANOPY TREE PER 40' CONTINUOUS HEDGE	21 TREES HEDGE	21 TREES COCOPLUM HEDGE
NATIVE TREE REQUIREMENT	50% OF REQUIRED TREES SHALL BE NATIVE NO MORE THAN 20% OF REQUIRED NATIVE TREES SHALL BE PALMS	124 TOTAL REQ. TREES 62 NATIVE TREES MIN 25 NATIVE PALMS MAX	158 NATIVE TREES 24 NATIVE PALMS
FOUNDATION PLANTINGS			
SHRUB REQUIREMENTS	1 SHRUB PER 6' O.C. (WITHIN 3' OF BASE) CANOPY TREES NEED 16' HT. MIN. PALMS NEED 22' O.A. HT. MIN	TYPE 1 BUILDING 111 SHRUBS TYPE 2 BUILDING 93 SHRUBS	TYPE 1 BLDG (#1&2) - 167 SHRUBS TYPE 2 BLDG (#3,4&5)- 182 SHRUBS
RESIDENTIAL CLUBHOUSE - 22'-6" HT.	8' WIDE PLANTER FOR BLDGS UP TO 15' HT. 1 ADD'L FOOT OF WIDTH PER EVERY 2' OF ADD'L HT. UP TO MAX WIDTH OF 24'. UP TO 50% WIDTH REDUCTION BY PROVIDING SUPERIOR LANDSCAPE DESIGN PER "155.5203.D.5"	12'-0" WIDE PLANTER	10' WIDE PLANTER WITH SUPERIOR LANDSCAPE ITEMS I, V, & VI PER "155.5203.D.5"
RESIDENTIAL GYM - 21'-8" HT.	8' WIDE PLANTER FOR BLDGS UP TO 15' HT. 1 ADD'L FOOT OF WIDTH PER EVERY 2' OF ADD'L HT. UP TO MAX WIDTH OF 24'. UP TO 50% WIDTH REDUCTION BY PROVIDING SUPERIOR LANDSCAPE DESIGN PER "155.5203.D.5"	12'-0" WIDE PLANTER	10' WIDE PLANTER WITH SUPERIOR LANDSCAPE ITEMS I, V, & VI PER "155.5203.D.5"
BUILDING TYPE 1 - 59'-0" HT.	8' WIDE PLANTER FOR BLDGS UP TO 15' HT. 1 ADD'L FOOT OF WIDTH PER EVERY 2' OF ADD'L HT. UP TO MAX WIDTH OF 24'. UP TO 50% WIDTH REDUCTION BY PROVIDING SUPERIOR LANDSCAPE DESIGN PER "155.5203.D.5"	24'-0" WIDE PLANTER	12' WIDE PLANTER WITH SUPERIOR LANDSCAPE ITEMS I, V, & VI PER "155.5203.D.5"
BUILDING TYPE 2 - 59'-10" HT.	8' WIDE PLANTER FOR BLDGS UP TO 15' HT. 1 ADD'L FOOT OF WIDTH PER EVERY 2' OF ADD'L HT. UP TO MAX WIDTH OF 24'. UP TO 50% WIDTH REDUCTION BY PROVIDING SUPERIOR LANDSCAPE DESIGN PER "155.5203.D.5"	24'-0" WIDE PLANTER	12' WIDE PLANTER WITH SUPERIOR LANDSCAPE ITEMS I, V, & VI PER "155.5203.D.5"

GOLF CLUBHOUSE - LANDSCAPE REQUIREMENT CHART

ITEMS	CODE REQUIREMENT	REQUIRED	PROVIDED
LOT LANDSCAPE - ZONING PR (279,707 SF SITE AREA)	2 TREES/5 SHRUBS PER 2,000 SQ. FT.	280 TREES 699 SHRUBS	355 TREES TOTAL 273 SHADE TREES (3 RELOCATES, 5 EXISTING) 82 PALMS (40 RELOCATES, 9 EXISTING) 9,198 SHRUBS
LOT LANDSCAPE - BASED ON ZONING DISTRICT LINE (279,707 SF SITE AREA) PR = 179,778 SF RM-45 = 99,929 SF	PR = 2 TREES/5 SHRUBS PER 2,000 SQ. FT. RM-45 = 1 TREES/5 SHRUBS PER 3,000 SQ. FT.	PR = 180 TREES 449 SHRUBS RM-45 = 93 TREES 167 SHRUBS	PR = 175 TREES 45 PALMS 2,587 SHRUBS RM-45 = 98 TREES 37 PALMS 6,611 SHRUBS
VEHICULAR USE AREA INTERIOR LANDSCAPING (80,105 SF)	15% OF VEHICULAR USE AREA	12,016 SF	PROVIDED 17.5% (14,056 SF) OF INTERIOR LANDSCAPING IN VEHICULAR USE AREA.
PARKING ISLANDS	1 TREE PER ISLAND	32 TREES SOD	32 TREES SOD
PARKING MEDIANS (330 LF)	1 CANOPY TREE PER 40' CONTINUOUS HEDGE	8 TREES HEDGE	8 TREES COCOPLUM HEDGE
NATIVE TREE REQUIREMENT	50% OF REQUIRED TREES SHALL BE NATIVE NO MORE THAN 20% OF REQUIRED NATIVE TREES SHALL BE PALMS	280 TOTAL REQ. TREES 140 NATIVE TREES MIN 56 NATIVE PALMS MAX	189 NATIVE TREES 10 NATIVE PALMS
FOUNDATION PLANTINGS			
GOLF CLUBHOUSE - 28'-6" HT.	8' WIDE PLANTER FOR BLDGS UP TO 15' HT. 1 ADD'L FOOT OF WIDTH PER EVERY 2' OF ADD'L HT. UP TO MAX WIDTH OF 24'. UP TO 50% WIDTH REDUCTION BY PROVIDING SUPERIOR LANDSCAPE DESIGN PER "155.5203.D.5"	15'-0" WIDE PLANTER	12' WIDE PLANTER WITH SUPERIOR LANDSCAPE ITEMS I, V, & VI PER "155.5203.D.5"
GOLF CART BARN - 21'-2" HT.	8' WIDE PLANTER FOR BLDGS UP TO 15' HT. 1 ADD'L FOOT OF WIDTH PER EVERY 2' OF ADD'L HT. UP TO MAX WIDTH OF 24'. UP TO 50% WIDTH REDUCTION BY PROVIDING SUPERIOR LANDSCAPE DESIGN PER "155.5203.D.5"	11'-0" WIDE PLANTER	11' WIDE PLANTER
GOLF MAINTENANCE FACILITY - 21'-2" HT.	8' WIDE PLANTER FOR BLDGS UP TO 15' HT. 1 ADD'L FOOT OF WIDTH PER EVERY 2' OF ADD'L HT. UP TO MAX WIDTH OF 24'. UP TO 50% WIDTH REDUCTION BY PROVIDING SUPERIOR LANDSCAPE DESIGN PER "155.5203.D.5"	11'-0" WIDE PLANTER	14' WIDE PLANTER

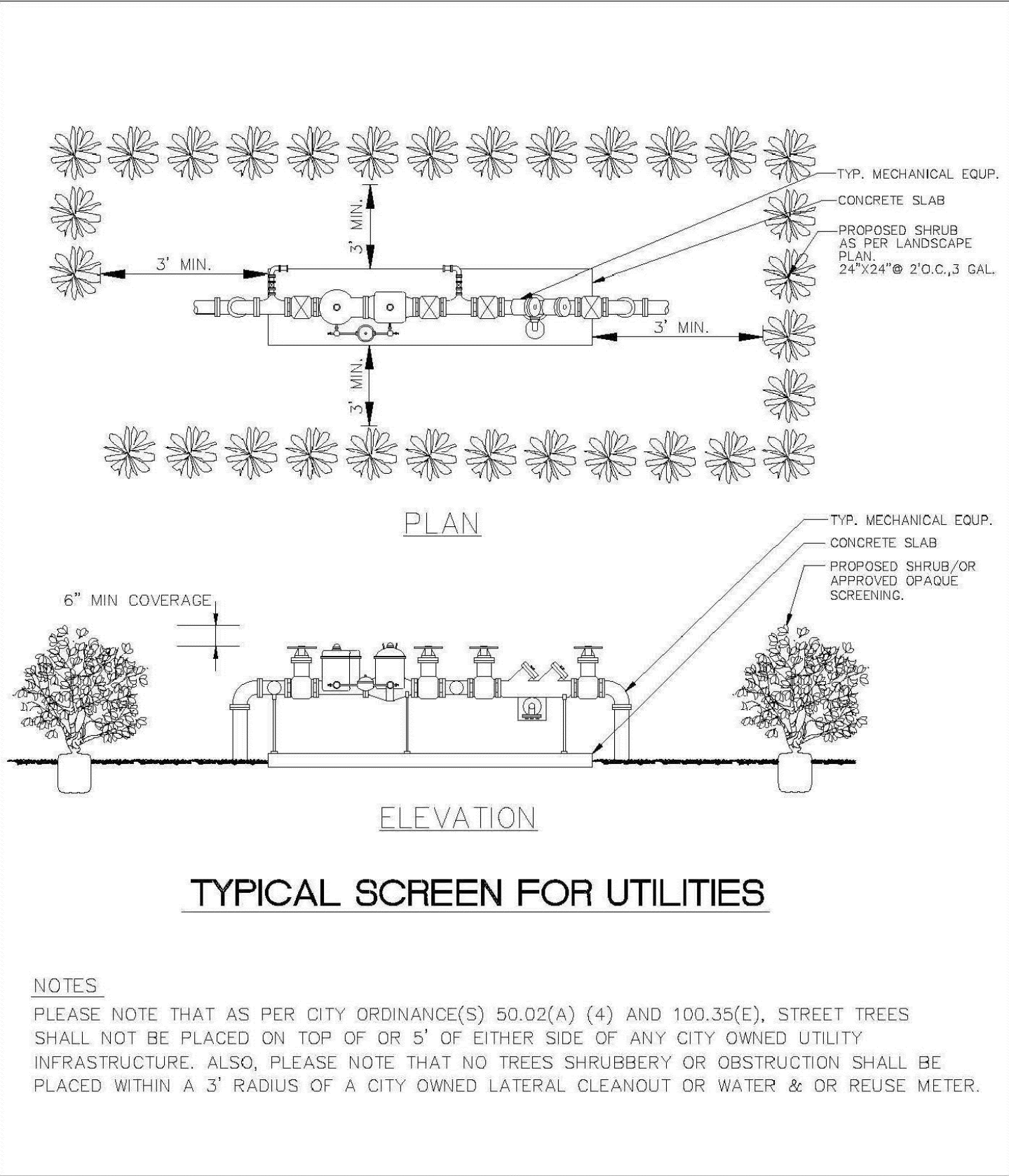

TYPICAL SCREEN FOR UTILITIES

NOTES:
PLEASE NOTE THAT AS PER CITY ORDINANCE(S) 50.02(A) (4) AND 100.35(E), STREET TREES SHALL NOT BE PLACED ON TOP OF OR 5' OF EITHER SIDE OF ANY CITY OWNED UTILITY INFRASTRUCTURE. ALSO, PLEASE NOTE THAT NO TREES' SHRUBBERY OR OBSTRUCTION SHALL BE PLACED WITHIN A 3' RADIUS OF A CITY OWNED LATERAL CLEANOUT OR WATER & OR REUSE METER.

ENGINEERING STANDARDS 2022

REVISIONS		ENGINEERING DIVISION CITY OF POMPANO BEACH	TYPICAL SCREEN FOR UTILITIES	
BY	DATE			
TCW	APRIL 2010	SCALE: N.T.S.	APPROVED BY:	DATE: MAY 2022 DWG. NO. 315-1

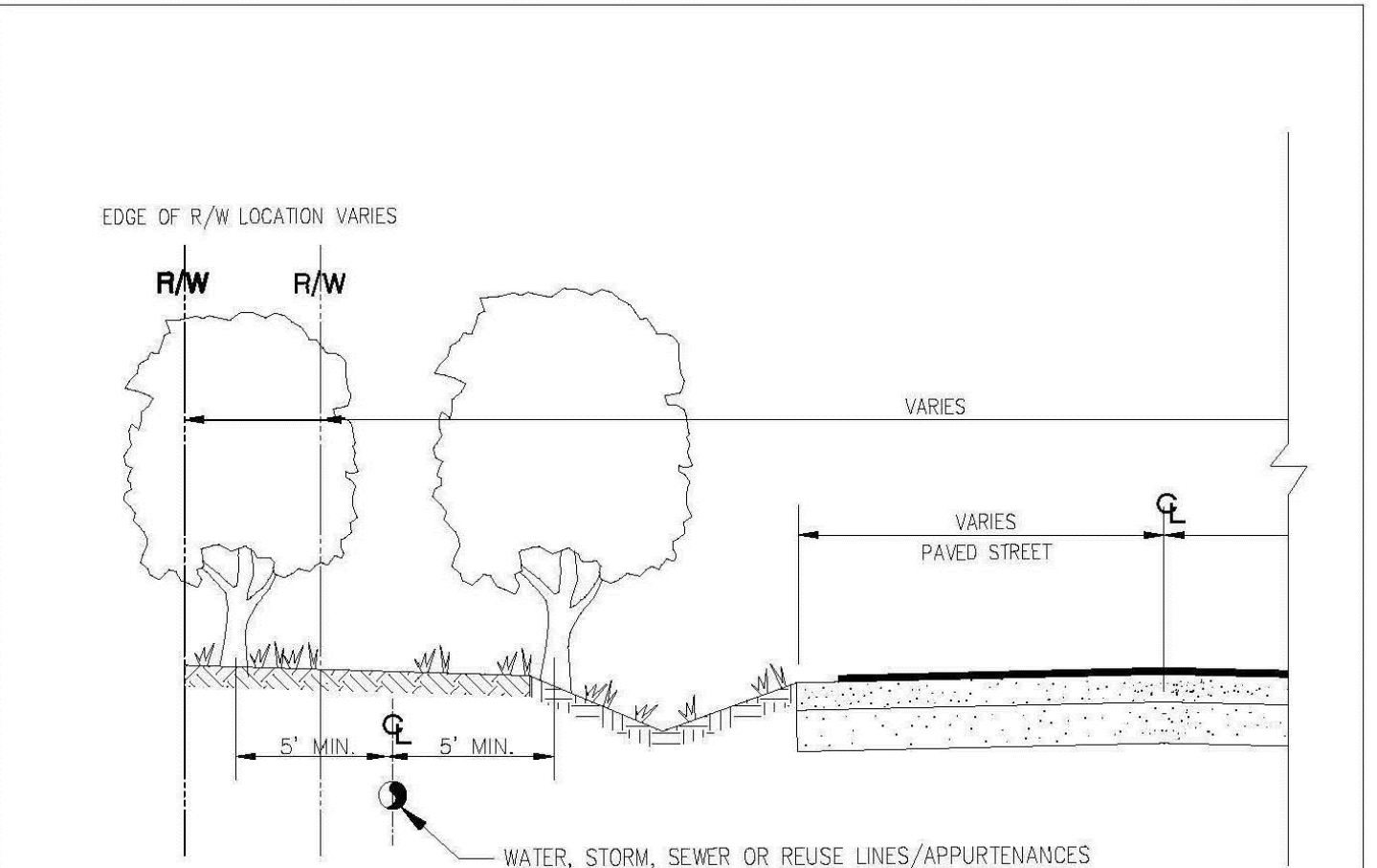

TREE LOCATIONS REQUIRED IN PUBLIC R/W ON UTILITY EASEMENTS

NOTES:
PLEASE NOTE THAT AS PER CITY ORDINANCE(S) 50.02(A) (4) AND 100.35(E), STREET TREES SHALL NOT BE PLACED ON TOP OF OR 5' OF EITHER SIDE OF ANY CITY OWNED UTILITY INFRASTRUCTURE. ALSO, PLEASE NOTE THAT NO TREES' SHRUBBERY OR OBSTRUCTION SHALL BE PLACED WITHIN A 3' RADIUS OF A CITY OWNED LATERAL CLEANOUT OR WATER & OR REUSE METER.

ENGINEERING STANDARDS 2022

REVISIONS		ENGINEERING DIVISION CITY OF POMPANO BEACH	REQUIRED TREE LOCATIONS	
BY	DATE			
		SCALE: N.T.S.	APPROVED BY:	DATE: MAY 2022 DWG. NO. 316-1

P&Z

insite studio

planning + landscape architecture

3601 PGA Blvd, Suite 220, Palm Beach Gardens, FL 33410
phone: 561-249-0940 | email: info@insitestudio.com
www.insitestudio.com | License# LC26000606

Consultants:

Revisions:
2023/06/12 - Intake
2023/08/16 - Resubmittal #1
2024/01/02 - Resubmittal #2
2024/10/16 - Resubmittal #3
2024/12/11 - Resubmittal #4
2025/01/27 - Resubmittal #5
2025/04/02 - Post-DRC Revisions
2025/05/01 - Post-DRC Revisions
2025/05/20 - P&Z Submittal

THE OAKS AT PALM AIRE
Pompano Beach, Florida
MORGUARD

ALWAYS CALL 811 TWO FULL BUSINESS DAYS BEFORE YOU DIG TO HAVE UNDERGROUND UTILITIES LOCATED AND MARKED.

Sunshine811.com

Drawn By: AS/JG/ZK
Drawing #: 1272
File Name: LP_1272.dwg
Date: 01/03/2024

LANDSCAPE
SCHEDULE & DATA

SHEET #: LP.31

PZ23-12000017
06-25-2025